

SN ...

- with O-ring made from NBR* (e.g. Perbunan)

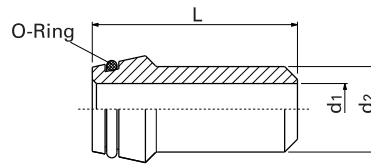

J

Welding nipple SN...

| Tube outer diameter | PN bar (psi) | Model | kg/100 pc. | d ₁ | L | O-ring | Art. no. |
|---------------------|--------------|--------------------|------------|----------------|------|------------|------------------|
| 8 | 400 (5801) | SN 8 x 2 | 1.1 | 4 | 31 | 6 x 1.5 | WAL028783 |
| 10 | 315 (4569) | SN 10 x 2 | 1.5 | 6 | 32.5 | 7.5 x 1.5 | WAL028784 |
| 12 | 400 (5801) | SN 12 x 2.5 | 2.2 | 7 | 32.5 | 9 x 1.5 | WAL028785 |
| 16 | 400 (5801) | SN 16 x 3 | 3.9 | 10 | 38.5 | 12 x 2 | WAL028788 |
| 20 | 250 (3626) | SN 20 x 3 | 6.0 | 14 | 44.5 | 16.3 x 2.4 | WAL028790 |
| | 400 (5801) | SN 20 x 4 | 7.4 | 12 | | | WAL068737 |
| 25 | 250 (3626) | SN 25 x 3 | 8.7 | 19 | 49.5 | 20.3 x 2.4 | WAL028792 |
| | 315 (4569) | SN 25 x 4 | 10.7 | 17 | | | WAL028793 |
| 30 | 250 (3626) | SN 30 x 4 | 14.0 | 22 | 52 | 25.3 x 2.4 | WAL028795 |
| | 315 (4569) | SN 30 x 5 | 16.5 | 20 | | | WAL028796 |
| | 400 (5801) | SN 30 x 6 | 18.6 | 18 | | | WAL604551 |
| 38 | 160 (2321) | SN 38 x 4 | 20.4 | 30 | 56.5 | 33.3 x 2.4 | WAL028797 |
| | 250 (3626) | SN 38 x 5 | 23.5 | 28 | | | WAL028798 |
| | 315 (4569) | SN 38 x 6 | 27.2 | 26 | | | WAL028799 |
| | 400 (5801) | SN 38 x 7 | 30.1 | 24 | | | WAL604552 |

*For FPM (e.g. Viton) see price list / available on request.

Do not fit the O-ring until after the welding process.

For stainless steel (1.4571), see price list / available on request