

System nuts with blanking end

P-VSK ...

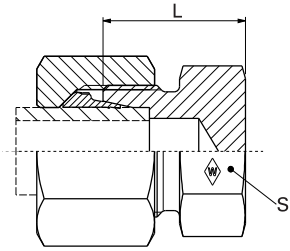

J

Blanking ends
P-VSK...

Series	PN bar (psi)	Tube outer diameter	M	Model	kg/ 100 pc.	L	S ₁	
L	500 (7252)	6	M 12 x 1.5	P-VSK 6 L	2.5	17	14	WAL608941
		8	M 14 x 1.5	P-VSK 8 L	4.1	17	17	WAL608942
		10	M 16 x 1.5	P-VSK 10 L	5.1	20	17	WAL608943
		12	M 18 x 1.5	P-VSK 12 L	6.4	21	19	WAL608944
	400 (5801)	15	M 22 x 1.5	P-VSK 15 L	10.5	20	24	WAL608945
		18	M 26 x 1.5	P-VSK 18 L	14.8	21	27	WAL608946
	250 (3626)	22	M 30 x 2	P-VSK 22 L	20.4	23	32	WAL608947
		28	M 36 x 2	P-VSK 28 L	30.2	23	41	WAL608948
		35	M 45 x 2	P-VSK 35 L	44.5	29	46	WAL608949
		42	M 52 x 2	P-VSK 42 L	68.7	30	55	WAL608950
S	800 (11603)	6	M 14 x 1.5	P-VSK 6 S	3.6	17	17	WAL608951
		8	M 16 x 1.5	P-VSK 8 S	4.5	17	17	WAL608952
		10	M 18 x 1.5	P-VSK 10 S	6.9	20	19	WAL608953
		12	M 20 x 1.5	P-VSK 12 S	9.3	21	22	WAL608954
	630 (9137)	14	M 22 x 1.5	P-VSK 14 S	11.8	23	24	WAL608955
		16	M 24 x 1.5	P-VSK 16 S	14.5	24	27	WAL608956
	420 (6091)	20	M 30 x 2	P-VSK 20 S	23.7	28	32	WAL608957
		25	M 36 x 2	P-VSK 25 S	43.9	31	41	WAL608958
		30	M 42 x 2	P-VSK 30 S	53.8	34	46	WAL608959
		38	M 52 x 2	P-VSK 38 S	83.8	38	55	WAL608960

Blanking ends for tube ends and taper-seal connections

VSK ...

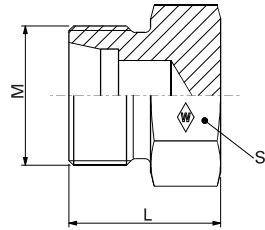

J

Blanking ends
VSK...

Series	PN (bar) (psi)	Tube outer diameter	Model	kg/ 100 pc.	Art. no.
L	500 (7252)	6	VSK 6 L	1.4	WAL609765
		8	VSK 8 L	2.4	WAL609766
		10	VSK 10 L	2.7	WAL372285
		12	VSK 12 L	3.4	WAL063311
	400 (5801)	15	VSK 15 L	5.9	WAL609767
		18	VSK 18 L	8.1	WAL061866
	250 (3626)	22	VSK 22 L	11.5	WAL609768
		28	VSK 28 L	20.5	WAL609769
		35	VSK 35 L	29.2	WAL609770
		42	VSK 42 L	44.9	WAL609771
S	800 (11603)	6	VSK 6 S	1.9	WAL609772
		8	VSK 8 S	2.5	WAL609773
		10	VSK 10 S	3.5	WAL371395
		12	VSK 12 S	5.3	WAL024051
	630 (9137)	14	VSK 14 S	6.2	WAL609774
		16	VSK 16 S	7.8	WAL063859
	420 (6091)	20	VSK 20 S	13.1	WAL063400
		25	VSK 25 S	22.9	WAL063312
		30	VSK 30 S	30.2	WAL602420
		38	VSK 38 S	50.2	WAL609775