



MiniCut 5-50

USER MANUAL
2017-08-29

Serial number: _____



Hydroscand was established 1969 in Stockholm, Sweden, by Björn Holmström.
The focus was, and still is, fluid connectors, hoses and fittings.

About 30 years ago, Hydroscand started developing and manufacturing machines for its own purpose. High quality and reliable performance in a demanding environment was the primary focus. Downtime and unnecessary service is always more expensive than the small extra cost of a quality product. That was the philosophy and still is for what became Hydroscand Machine AB in Säter, 20 years ago.

Today Hydroscand Group has a turnover of 190 million Euro and is present in many countries in Europe, Asia and Africa. Hydroscand Machine has expanded it's business to worldwide exports.

No matter where in the world you are, always know that: We stand by our machines.

CONTENTS

1. INTRODUCTION	4
2. GENERAL PRECAUTIONS	5
3. EQUIPMENT	6
3.1 WARRANTY	6
3.2 IMPORTANT	6
4. MACHINE.....	7
4.1 IDENTIFICATION	7
4.2 DESCRIPTION	7
5. STARTING UP	8
5.1 PRELIMINARY STEPS.....	8
5.2 OPERATOR POSITION	8
5.3 STARTING UP	8
6. HOSE CUTTING	9
6.1 TO MAXIMIZE THE LIFE TIME OF THE CUTTING BLADE.....	9
6.2 DIFFERENT HOSE DIMENSIONS	9
7. MAINTENANCE.....	10
7.1 REPLACING THE CUTTING BLADE.....	10
7.2 AFTER EACH WORKING SHIFT	10
7.3 REGULAR MAINTENANCE.....	10
8. PICTURE	11
9. TECHNICAL DATA	12
10. ELECTRICAL DRAWINGS.....	13
10.1 SINGLE PHASE 230V.....	13
10.2 THREE PHASE 230V.....	14
10.3 THREE PHASE 400V.....	15
10.4 12V.....	16
11. SPARE PART LIST	17

1. Introduction

This information is the result of continuous, systematic data processing and technical tests recorded and validated by the manufacturer, in accordance with the internal procedures to ensure the safety of information: 2006/42/EC.

The information below is intended EXCLUSIVELY for specialized users, capable of interacting with the product with the utmost safety people, the machine and the environment, interpreting basic diagnostics of problems and malfunctions and performing simple checks and maintenance, in full compliance with the instructions given from the pages that follows and with current health and safety regulations.

The manual does not examine in depth the topics of disassembly and extraordinary maintenance, as these operations must always be carried out by our authorized Technical Service.

To handle the machine properly, it is necessary to keep the manual in good condition for the future. Contact the nearest authorized technical service if you need a new manual or more complete information.

Before each intervention to the machine or its packaging, read the instructions in the following manual very carefully.

Every operator using the machine MUST read the following instructions before operating.

Hydroscand Machine AB declines any responsibility for damage to persons, things or to the machine itself, arising from its incorrect use, negligence and superficial interpretations of safety concepts in this manual.

This instruction manual should serve for the duration of the cutting machine's operating life and be available for at least 10 (ten) years. We recommend to keep it in a known and accessible place (possible together with other documents related to the machine).

2. General precautions

Always make sure in advance that the minimum safety, placement and operating standards are respected, taking note of the environmental conditions, temperature, humidity, lighting, vibrations, suspended dust and the appropriateness of the area to be occupied.

The cutting machine is constructed to operate indoors (workshops, industries etc.) where there is no risk of explosion or fire.

Before cutting the first hose, make sure that the cutting blade rotates in the correct direction (see rotation arrow) and that the hose is placed steady towards the adjustable cutting support. Also make sure that the hose is held steady so that there will be no risk for injuries or damages.

When cutting hoses, the cutting supports (2 pcs) must be used.

Do not remove the information plates on the cutting machine. Make sure they are readable and that you are sure about their meaning. Should they deteriorate, replace them immediately by contacting only an authorized Technical Service.

The use of spares that do not respond to the specifications listed below, changes or manipulations - however slight- shall exempt Hydroscand Machine AB from any responsibility regarding the proper use and functioning of the cutting machine and safety of people and/or property.

It is strictly forbidden to tamper with safety equipment and or devices.

Dispose of processing waste in compliance with current regulations.

NOTE!

Skilled personnel co-ordinated by authorized Technical Service must carry out any maintenance operations, except for those specifically described on the pages of this manual.

3. The equipment

Our stationary hose cutting machine is supplied ready to use (except for the plug), packed on a pallet.

NOTE !

The packing material must be disposed according to current environmental protecting regulation.

The machine is supplied initially with:

- Cutting blade 300x3x50 mm, part No: 9003-00-04, assembled. For Mini-Cut 12V machine is supplied with 9003-00-05.
- 2 pcs of Bend support
- Instruction manual
- Certificate regarding agreement according to CE-standards

3.1 Warranty

The cutting machine is guaranteed for one (1) year following the date of purchase; the warranty is valid only if all of the instructions listed on the warranty certificate and in this manual are fully complied with.

NOTE !

When unpacking the cutting machine, make sure that the machine is in perfect condition and that the package contains the parts described. Hydroscand Machine AB does not respond for errors or missing parts not reported to Hydroscand Machine AB following eight (8) days after shipment.

3.2 Important

The hose cutting machine is designed, manufactured and protected for cutting 1- and 2-layers hydraulic hose with dimension from 3/16" up to 2". Any other use is excluded by Hydroscand Machine AB, who shall be exempt from any liability for damage to people, property or the machine itself, caused by improper use. Do not leave the cutting machine idle running for longer periods, without cutting anything.

Do not cut solid steel, wood or other unknown material, that can cause damage to people, property or the machine itself.

4. The machine

4.1 Identification

The information for identifying the machine is found on the plates, located outside of the cutting machine. This essentially includes:

- Manufacturer • Serial number • Year of manufacture • Voltage (V)
- Hertz (Hz) • Amperes (A) • Weight

The CE- approval plate is located at the back of the machine, on the top to the right.

NOTE !

It is strictly forbidden to remove or damage the plate. Should this happen, always contact an authorized Technical Service only.

For any information and/or technical explanations regarding the cutting machine, always indicate:

- Model • Edition and preparation date of the instruction manual
- Serial number

4.2 Description

The hose cutting machine consists of one unit, equipped with a handle which is manually manoeuvred and flap doors that are pressed away by the hose during the cutting process. The unit is also equipped with a connection for a smoke evacuator (option) and as standard with a smooth cutting blade assembled on the machine except the MiniCut 12V. Standard for 12V is toothed blade.

The hose cutting machine must only be used for hydraulic hoses compatible with the specifications below. Follow the environmental conditions and limitations recommended by Hydroscand Machine AB and current health and safety regulations.

NOTE !

The descriptions includes the use for which the machine has been designed, built and protected. Any other use or failure to comply with the technical parameters listed below, may constitute a hazard to people and/or property.

5. Starting - up

5.1 Preliminary steps

Important!

It is essential to determine size measurements and placement in advance in order to ensure safe placement, running and emergency actions within the surrounding environment. These conditions should be respected beginning with the preliminary stages, before cutting begins.

- Place the machine on a steady and flat foundation.
- Check that the cutting blade can rotate freely.
- Check that the handle can move freely back and forward.
- Check that the cutting blade is tightened.

NOTE !

Before plugging-in the machine, make sure that the line voltage corresponds to the voltage indicated on the machine. If the voltage is 12V, connect red to positive pole and blue to negative pole. Always use goggles and earplugs when working with the machine.

5.2 Operator position

The placement of the machine in relation to the operator's position must make it possible to observe the result of the operation and maintain safety conditions. During this stage, make sure that the start/stop button and safety switch not are blocked and that there is sufficient visibility and lightning on the machine, the surrounding area and base.

5.3 Starting - up

Release the emergency button by turning it clockwise. Press the START-button and pull the handle backwards for cutting.

Caution!

Check the direction of rotation (the upper edge of the cutting blade shall rotate towards the cutting table). If the machine starts to vibrate heavily, stop the machine immediately and check the reason for the vibrations.

6. Hose cutting

6.1 To maximize the lifetime of the cutting blade

1. The 200 first cuts on a new cutting blade should be cut with caution.
2. After these 200 first cuts, the cut should be fast but without overloading of the motor.
3. Do not overheat the cutting blade.

6.2 Different hose dimensions

Important !

When cutting...

... hoses of dimension 3/16"- 1/2" must the prebend supports always be used and put in the two inner holes. Min. cutting length 150 mm.

... hoses of dimension 5/8"- 1" must the prebend supports always be used and put in the two middle holes. Min. cutting length 250 mm.

... hoses of dimension 1 1/4"- 2", must the prebend supports always be used and put in the two outer holes. Min. cutting length 300 mm.

Now the machine is ready for cutting these hose dimensions.

7. Maintenance

7.1 Replacing the cutting blade

Warning !

Always use protective gloves when changing the cutting blade.

- Disconnect the electric supply.
- Open the lid on the back side and the lid on the LEFT hand side.
- Loosen the hexagon headed screw by using a 6 mm hexagon head socket wrench.
- The cutting blade is now loose. Dismantle the old blade and assemble a new one.
- Mount the new blade and screw the adapter plate tightly with the centre bolt.
- Moment of torsion is 9,8 Nm for M6 and 24 Nm for M8.

Important !

Start the cutting machine and check that no vibrations occur. Make a test cut to make sure that the cutting blade is thoroughly tightened.

7.2 After each working shift

- Press the emergency stop button and remove cutting waste.

7.3 Regular maintenance

- Make sure that the cutting blade is in good condition, that no cracks have occurred.
- Open the waste box. Remove cutting waste.
- Check that there are no defects on electrical connections or cables.



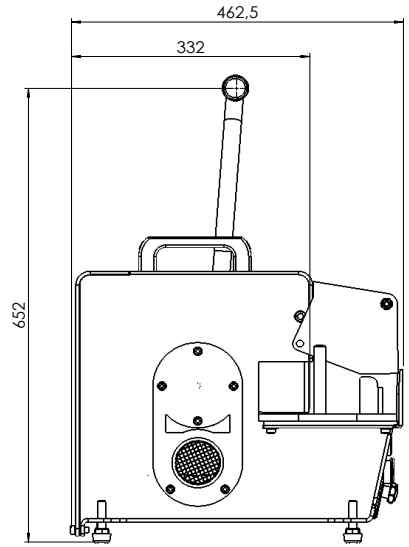
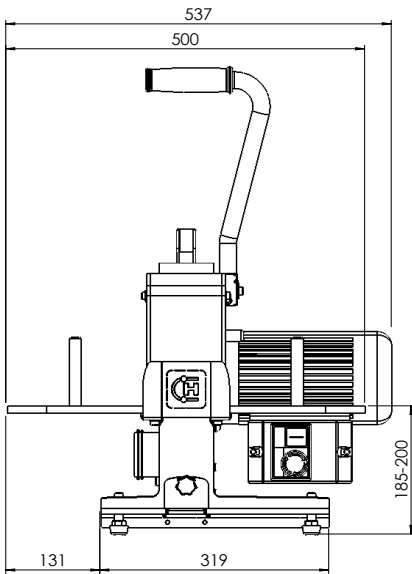

DESIGNATION:

MiniCut 5-50 400 V 3-phase	9006-01-00
MiniCut 5-50 230 V 1-phase.....	9006-02-00
MiniCut 5-50 12 V	9006-03-00

PART NUMBER:

SPARE PARTS:

Cutting blade HSM 300x3x50 Smooth	9003-00-04
Cutting blade HSM 300x3x50 Toothed	9003-00-05

PART NUMBER:

TECHNICAL DATA

Hose capacity 1-2 layer, single and 3 phase	3/16" – 2"
Hose capacity 1-2 layer, 12 V	1/4" – 1 1/4"
Hose capacity 4 layer, single and 3 phase ..	1/4" – 1 1/4"
Hose capacity 4 layered, 12 V.....	1/4" – 3/4"
Max. hose diameter	80 mm
Motor 12 V/single/3-phase.....	1,8/2,2/3,0 kW
Voltage 3 - phase.....	230/400V/16A/50Hz
Voltage single phase	230/16A/50Hz
Velocity	2750 rpm
Diameter (blade), ext	300 mm
Diameter (blade), int.....	50 mm
Connection to smoke evacuation system.....	63 mm
Colour.....	Black/Orange

10. Electrical drawings

10.1 SINGLE PHASE 230V

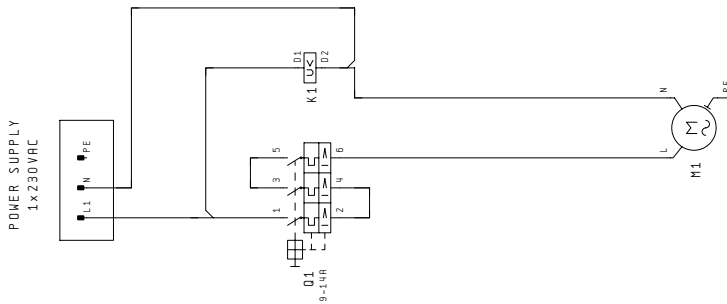

POS	QTY	DESCRIPTION	ORDER NO.	SUPPLIER
01	1	MOTORPROTECTION GV2ME-9-14A	3116520	SCHNEIDER
01	1	COVER GV2-MC01	3116140	SCHNEIDER
01	1	EM-PUSHBUTTON GV2-K04	3116164	SCHNEIDER
K1	1	LOM_VOLTAGE_PROTEC_GVAU225	3116650	SCHNEIDER



CIRCUIT DIAGRAM

1 x 230VAC

HYDROSCAND MACHINE

DATE	05.JUL.2005		
DESIGN	THM		
REV. DATE	05.JUL.2005	Verif.	
Revision		Norm	

MINICUT 1x230VAC

10. Electrical drawings

10.2 THREE PHASE 230V

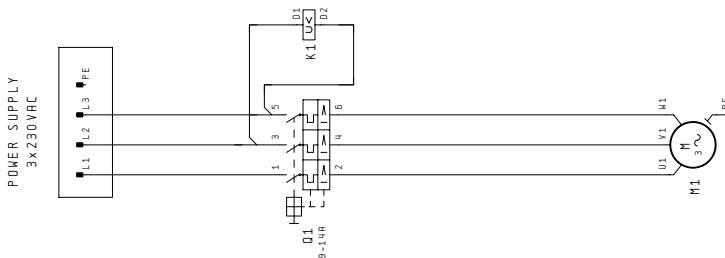

POS	QTY	DESCRIPTION	ORDER NO.	SUPPLIER
01	1	MOTORPROTECTION GV2ME-9-14A	3116520	SCHNEIDER
01	1	COVER GV2-MC01	3116140	SCHNEIDER
01	1	EM-PUSHBUTTON GV2-K04	3116164	SCHNEIDER
K1	1	LOM VOLTAGE PROTEC. GVAV225	3116650	SCHNEIDER

DATE	05.Jul.2005			
Desig:	THW			
Rev. date	05.Jul.2005	Verif.:		
Revision		Norm		
MINICUT 3x230VAC		CIRCUIT DIAGRAM		
		3x230VAC		HYDROSCAND MACHINE
				p. 1 I. p.



10. Electrical drawings

10.3 THREE PHASE 400V

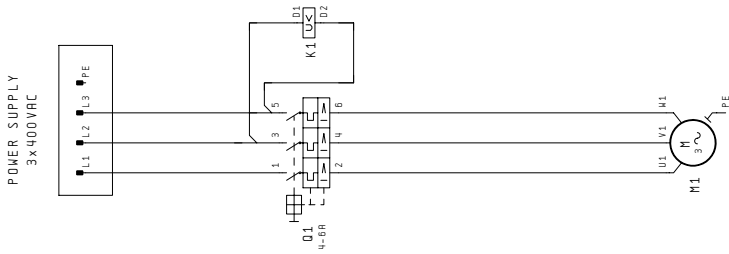

POS	QTY	DESCRIPTION	ORDER NO.	SUPPLIER
01	1	MOTORPROTECTION GV2ME-4-6-30	3116516	SCHNEIDER
01	1	COVER GV2-MC01	3116140	SCHNEIDER
01	1	EM-PUSHBUTTON GV2-K04	3116164	SCHNEIDER
K1	1	LOM_VOLTAGE_PROTEC_GVAU385	3116652	SCHNEIDER



MINICUT 3x400VAC

DATE	05_JUL_2005		
DESIGN	THM		
REV-GATE	05_JUL_2005	Verif:	
Revision		Norm	

CIRCUIT DIAGRAM

3x400VAC

HYDROSCAND MACHINE

p. 1
I.P.

11. Spare part list

Rev. No.	Revision information	Sign.	Appr. by	Checked date
Pos.	Artikelnummer Part number	Ritingsnummer Drawing number	Beskrivning Description	Antal Qty
1	90184067	S023101	Body assy	1
2	90180307	S023006	Cutting unit MC 5-50	1
3	90184077	S023102	Back plate assy	1
4	90184083	S023103	Pusher assy	1
5	90180305	10440	Machine foot mc	4
6	90184086	D023123	Guide roller	3
7	90184085	D023122	Pipe for handle mc	1
8	90181274	Extension spring	Spring 2x15dyx90	1
9	90184080	D023120	Table mc	1
10	90180314	10325 22 120	Handle	1
11	90184043	S023105	Kugg väglid	1
12	90184057	D023109	Protection plate MC	1
13	90180313	S023009	Electric box	1
14	90180294	10041	Exhaust	1
15	90184062	D023114	Blade Cover	1
16	90184074	S023106	Safety cover	1
17	90184091	sms2374 8x20	Cylindric pin	2
18	90184084	D023121	Safety cover button	2
19	90183550	Spambircka 8	Lock washer	2
20	90184087	D023124	Spring arm	1
21	90184076	D023119	Electric plate	1
22	90184058	D023110	Waste box MiniC	1
23	90184220	S023107	Retaining screw plate	1
24	90184056	D023108	Exhaust blade	1
25	90184066	D023115	Safety cover bracket	1
26	90180298	D023053	Bend support mc	2
27	90180293	D023032	Spring support mc	2
28	90180304	10328	"Wibberger wnl 30 132-m8"	1
29	90184213	10580	GFM-1.618-04	1
30	90184089	Wibberger-an476	1-Klammfalle GN476	1
31	90184214	D023126	Shaft for hatch	1
32	90183818	10348	GTM 1628-010	1
33	90010937	dn705 16	Stopring dn705 16	1
34	90182333	10387 03 6x10	Star screw	1
35	90175172	N6 M16x1	M6 Kuppl	5
36	90175027	SC MC65	M6 x 20	15
37	90175002	Wg BRB	M6	19
38	90184090	SC Passbufl	8 x 12 M6	3
39	90175361	Wg SRKB	M6	1
40	90175007	SC MC65	M8 x 20	2
41	90175094	SC MF65	M6 x 16	5
42	90175178	SC MC65	M6 x 8	2
OPT.	Material	Weight(kg)	Part No.	Date
		54,99		2017-02-07
	Scale	1:5	Part Name	
	Drawing No	NH	MiniCut EDII	
	Approved by	A3	S023100	



PROPRIETARY AND CONFIDENTIAL
 THE INFORMATION CONTAINED IN THIS DRAWING IS THE SOLE PROPERTY OF HYDROSCAND
 AND IS TO BE USED ONLY FOR THE SPECIFIC MACHINE AND WITHOUT THE WRITTEN
 PERMISSION OF HYDROSCAND MACHINE AB IS PROHIBITED.

For measures without
 drawings:
 is: ra 3,2
 General surface finish:
 is: ra 3,2
 Sharp edges broken.

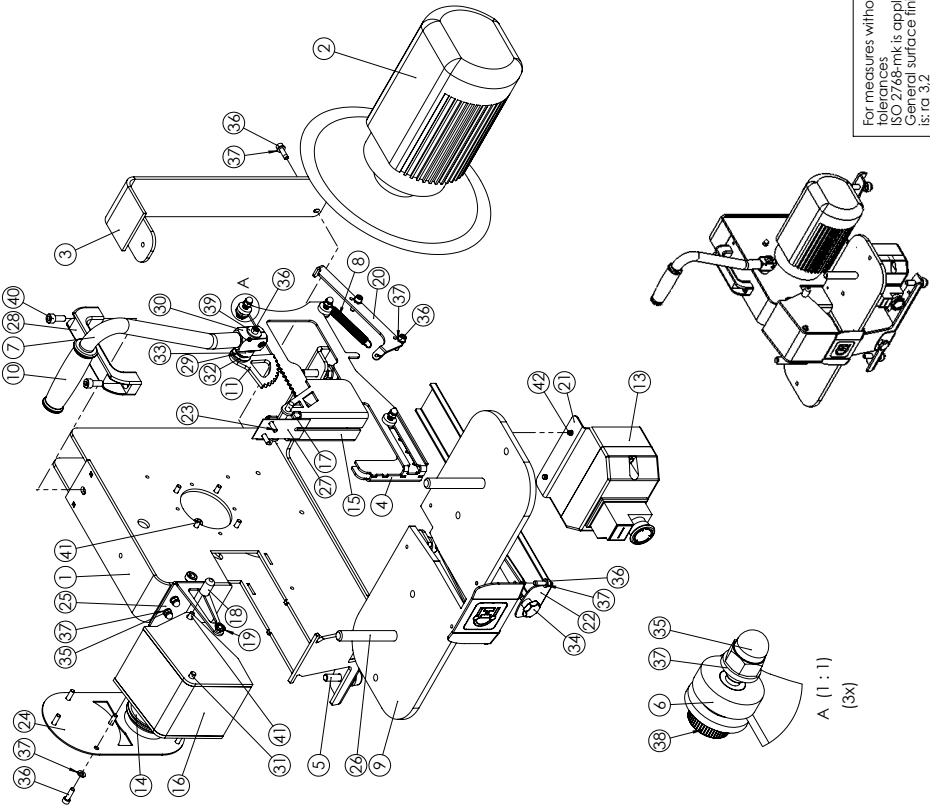

11. Spare part list

Pos.	Artikelnnummer Part number	Ringsnummer Drawing number	Beskrivning Description	12V/ QTY.
1	90184067	S023101	Body assy	
2	90180316	S023026	Cutting unit 12 v mc	
3	90184077	S023102	Back plate assy	
4	90184083	S023103	Pusher assy	
5	90180305	T0440	Machine foot mc	4
6	90184066	D023123	Guide roller	3
7	90184085	D023122	Pipe for handle mc	
8	90181274	Extension Spring	Spring 2x15dayx90	
9	90184080	D023120	Table mc	
10	90180314	T0325_22_120	Handle	
11	90184063	D023105	Kugg vald	
12	90184057	D023109	Protection plate MC	
13	90184279	E1063	Electric kit 12/24V mc	
14	90180294	T0041	Exhaust	
15	90184062	D023114	Blade Cover	
16	90184074	S023108	Safety cover	
17	90184091	sm3237/4-8x20	Cylindric pin	2
18	90184084	D023121	Safety cover button	
19	90183550	Sparnäckra 8	Lock washer	2
20	90184087	D023124	Spring arm	
21	90184275	D023130	Electric plate 12v mc	
22	90184058	D023110	Waste box MiniCut	
23	90184220	D023107	Retaining screw plate	
24	90184056	D023108	Exhaust blade	
25	90184066	D023115	Safety cover bracket	
26	90180298	D023053	Bend support mc	2
27	90180293	D023032	Spring support mc	
28	90180304	T0328	"Wibergier wnl 30 132 mm8"	
29	90184213	T0580	GFM-1,618-04	
30	90184089	gn476	I-Klämmolare GN476	
31	90184214	D023126	Shaft for hatch	
32	90183818	T0548	GFM 1,628-010	
33	90010937	din705-16	Stoppning din705 16	
34	90182333	T0387 M6x10	Star screw	1
35	90175172	DIN 1582	NJ MHM M6 Kupol	5
36	90175077	ISO 4762	SC MCGS M6 x 20	15
37	90175002	Washer ISO 7089	M6	22
38	90184090	Possibull	8 x 12 M6	3
39	90175361	ISO 7094	WA SRKB 6,4x20x2	1
40	90175007	ISO 4762	SC MCGS M6 x 20	2
41	90175178	ISO 4762	SC MCGS M6 x 8	5
42	90175094	ISO 10642	M6 x 16	5
43	90180331	S023014	Hood	1
44	90183672	D023087	Side plate mc	

Rev. No.	Revision information	Sign.	Appr. by	Checked date

HYDROSCAND
MACHINER AB, VÄSTERÅS

PROPRIETARY AND CONFIDENTIAL
THE INFORMATION CONTAINED IN THIS DRAWING IS THE SOLE PROPERTY OF HYDROSCAND
AND IS TO BE USED ONLY FOR THE SPECIFIC PROJECT AND WITHOUT THE WRITTEN
PERMISSION OF HYDROSCAND MACHINE AB IS PROHIBITED.

Scale: 1:5
Drawing size: A3

Partname: MiniCut ED II 12/24V
Approved by: S023100
Date: 2017-02-07

Weight (kg):
Partno.:
Date: 2017-02-07

0

SHEET 2 OF 3

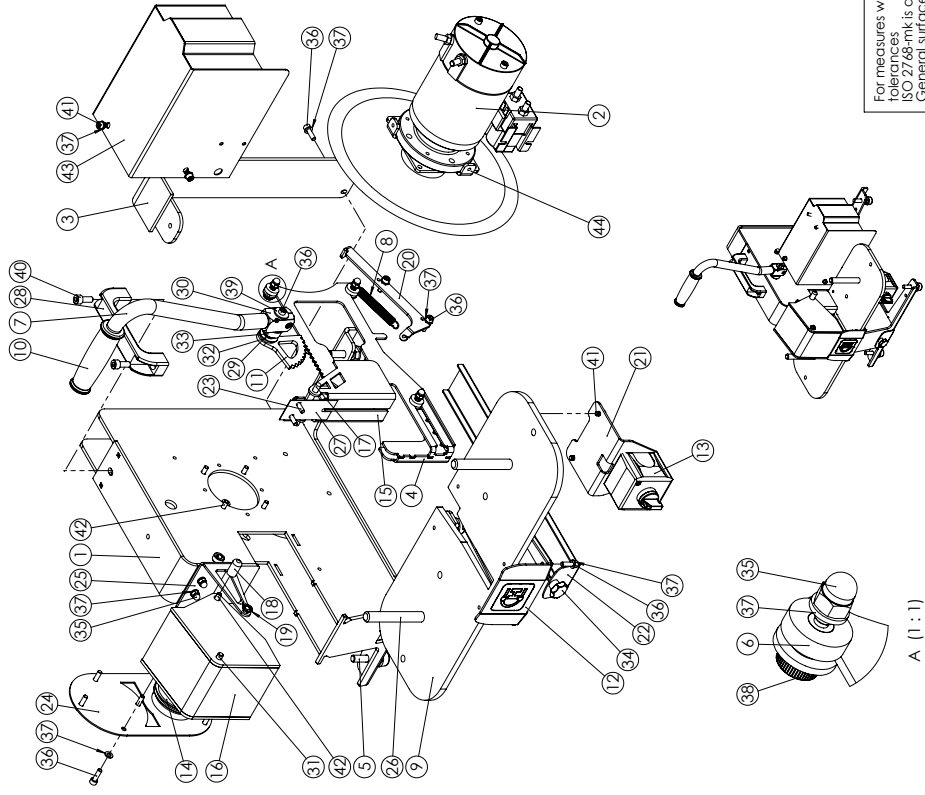

For measures without
ISO 9001:2015
certification is applied.
General surface finish
is: ra 3,2
Sharp edges broken.

A (1:1)

11. Spare part list

Rev. No.	Revision information	Sign.	Appr. by	Checked date

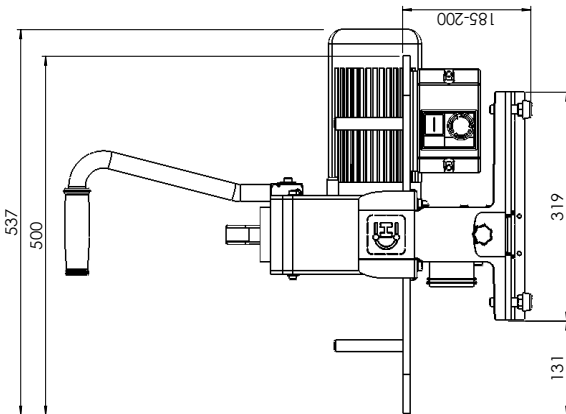
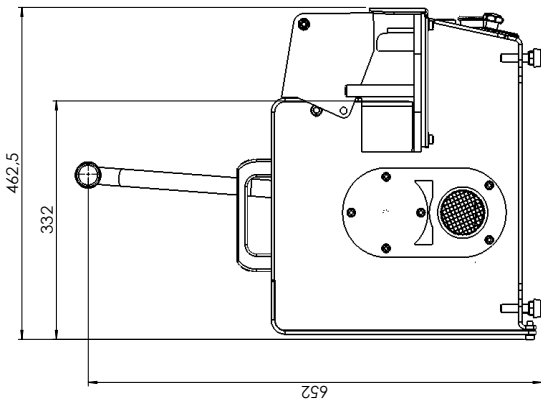

QTY.	Material	Weight (KG)	Part no.	Date	2017-06-21
Scale		Drawn by	Drawn by	Rev.	
1:5		NH	NH	0	
Drawing size		Approved by	Draw. No.	Rev.	
A3		S023100	S023100	0	



PROPRIETARY AND CONFIDENTIAL
 THE INFORMATION CONTAINED IN THIS DRAWING IS THE SOLE PROPERTY OF HYDROSCAND
 AND IS TO BE USED ONLY FOR THE PROJECT AND SITE SPECIFICALLY IDENTIFIED. NO
 REPRODUCTION OR TRANSMISSION OF THIS DRAWING OR ANY PART THEREOF IS
 PERMITTED WITHOUT THE WRITTEN PERMISSION OF HYDROSCAND MACHINE AB IS PROHIBITED.



SHEET 3 OF 3

Checked date

Revision information

Rev. No.

11. Spare part list

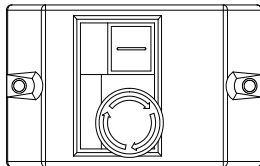
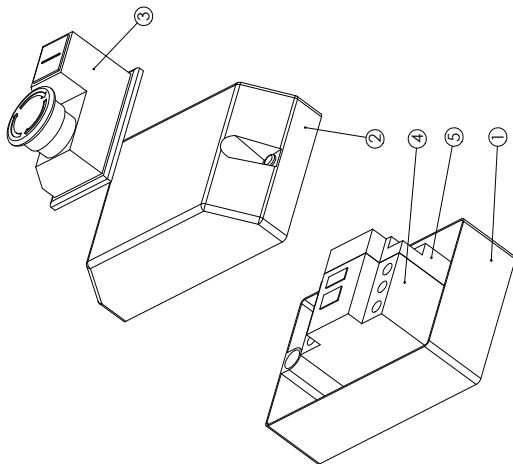

ITEM NO.	QTY.	PART NO.	DESCRIPTION
1	1	E0082	Electric box, box
2	1	E0083	Electric box, Cover
3	1	E0085	Switch
4	1	E0086	Motor circuit breaker
5	1	E0087	Voltage clips

PART LIST		Dimension	Weight	Date
QTY.	Material	Drawn by	0:354	2002-12-02
		Approved by	TK	
		Scale	1:2	
		Drawing tab	Std.no.	
		Drawn by	S023009	
		Rev.	0	



För ej toleranssatta mått
gäller ISO 2768-m.
Yfintnet där annat
ej anges: ra 3,2
Skarpa kanter bruha.

Esslinger Dwg no.

Rev. No.	1	Revision information	Bplt and spacer changed.	Checker date	2014-04-14
----------	---	----------------------	--------------------------	--------------	------------

11. Spare part list

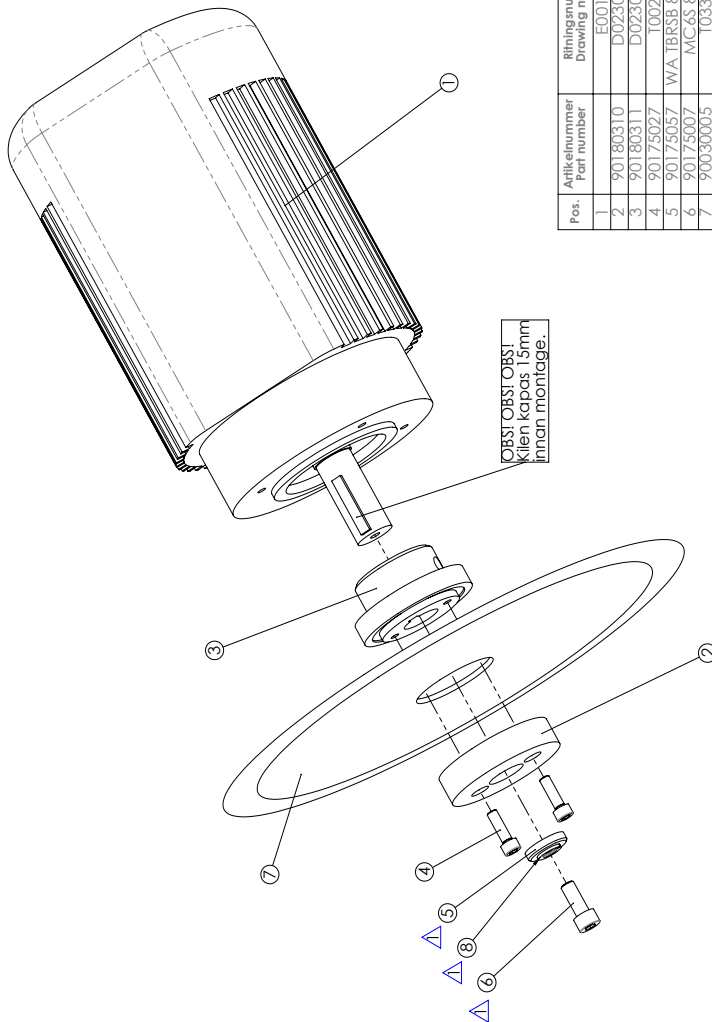

Pos.	Artikelnummer Part number	Rifningsnummer Drawing number	Description	Antal Qty
1	90180310	E0011	Motor 3fas 3kW mc	1
2	90180311	D023019	Outer carrier plate200-400V	1
3	90180311	D023018	Inner carrier plate 200-400V	1
4	90175027	I0025	MC6S 6x20,8,8.F7B	2
5	90175057	WA TBR58.8.4x2.6x5	Washer	1
6	90175007	MC6S 8x20	Washer	1
7	90030005	T0337	Cutting blade 300-50	1
8	90175263	WA FBB MB	Cutting blade 300-50	1

QTY:	Metresl	Drawn by	Date
		KB	2002-05-29
Scale	1:2	Approved by	Part name
		TK	Cutting unit 200-400V
Drawing size		Sheet no.	Rev.
A3		S023006	1

PART LIST	
HYDROSCAND	MACHINER AB

Pungmakarbovägen 1, SE-783 90 Säter, Sweden
Phone: +46-(0)225-573 30 Fax: +46-(0)225-501 08
info@hydroscand-machine.se www.hydroscand-machine.se

