

RED ... -WD/...

RED ... -WD/...-1.4571

- With soft seal made from NBR** (e.g. Perbunan) for steel
- With soft seal made from FKM (e.g. Viton) for stainless steel (1.4571)
- Inch studs type E to DIN EN ISO 1179-2

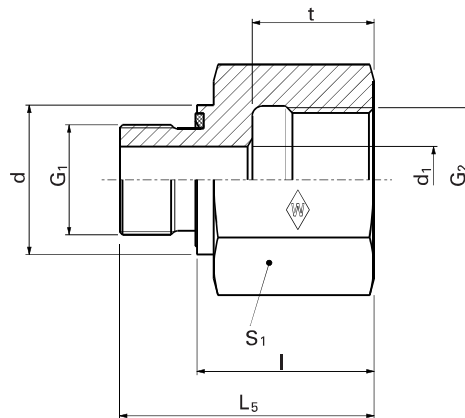

H

PN bar (psi)	DIN - ISO 228 (R..., DIN 259) G ₁	G ₂	Model	kg/100 pc.	L	l	d	d ₁	t	S ₁	Stud	Art. no.	Art. no.
											RED ... -WD/...	RED ... -WD/...	RED ... -WD/...
400 (5801)	G 1/8 A	G 1/4	RED-R 1/8-WD/R 1/4	3.6	31	23	13.9	4	17	19	Stud Stainless steel (1.4571)	WAL606613	WAL612430
		G 3/8	RED-R 1/8-WD/R 3/8	4.5	32	24	13.9	4	17	24	RED ... -WD/... VI-1.4571	WAL606614	WAL612431
	G 1/4 A	G 1/8	RED-R 1/4-WD/R 1/8	3.6	29	17	18.9	5	12	19	RED ... -WD/... VI-1.4571	WAL606615	WAL615402
		G 3/8	RED-R 1/4-WD/R 3/8	6.6	36	24	18.9	5	17	24	RED ... -WD/... VI-1.4571	WAL606616	WAL610621
		G 1/2	RED-R 1/4-WD/R 1/2	8.5	40	28	18.9	5	20	30	RED ... -WD/... VI-1.4571	WAL606617	WAL610620
	G 3/8 A	G 3/4	RED-R 1/4-WD/R 3/4	17.3	43	31	18.9	5	22	36	RED ... -WD/... VI-1.4571	WAL606618	WAL617815
		G 1/4	RED-R 3/8-WD/R 1/4	3.0	36	24	21.9	8	17	22	RED ... -WD/... VI-1.4571	WAL606619	WAL615403
		G 1/2	RED-R 3/8-WD/R 1/2	9.0	41	29	21.9	8	20	30	RED ... -WD/... VI-1.4571	WAL606620	WAL612429
	G 1/2 A	G 3/4	RED-R 3/8-WD/R 3/4	17.5	44	32	21.9	8	22	36	RED ... -WD/... VI-1.4571	WAL606621	WAL615482
		G 3/8	RED-R 1/2-WD/R 3/8	9.5	37	23	26.9	12	17	27	RED ... -WD/... VI-1.4571	WAL606622	WAL612095
		G 3/4	RED-R 1/2-WD/R 3/4	18.0	46	32	26.9	12	22	36	RED ... -WD/... VI-1.4571	WAL606623	WAL611320
			G 1	RED-R 1/2-WD/R 1	22.5	49	35	26.9	12	24.5	41	RED ... -WD/... VI-1.4571	WAL606624
250 (3626)	G 1/2 A	G 1 1/4	RED-R 1/2-WD/R 1 1/4	47.0	53	39	26.9	12	26.5	55	RED ... -WD/... VI-1.4571	WAL606625	WAL615487
400 (5801)	G 3/4 A	G 1/2	RED-R 3/4-WD/R 1/2	15.0	43	27	31.9	16	20	32	RED ... -WD/... VI-1.4571	WAL606626	WAL612017
		G 1	RED-R 3/4-WD/R 1	23.5	51	35	31.9	16	24.5	41	RED ... -WD/... VI-1.4571	WAL606627	WAL615220
250 (3626)	G 3/4 A	G 1 1/4	RED-R 3/4-WD/R 1 1/4	48.3	55	39	31.9	16	26.5	55	RED ... -WD/... VI-1.4571	WAL606628	WAL615412
		G 1 1/2	RED-R 3/4-WD/R 1 1/2	54.5	57	41	31.9	16	28.5	60	RED ... -WD/... VI-1.4571	WAL606629	WAL615508
400 (5801)	G 1 A	G 3/4	RED-R 1 -WD/R 3/4	28.0	49	31	39.9	20	22	41	RED ... -WD/... VI-1.4571	WAL606630	WAL611989
250 (3626)	G 1 A	G 1 1/4	RED-R 1 -WD/R 1 1/4	51.0	57	39	39.9	20	26.5	55	RED ... -WD/... VI-1.4571	WAL606631	WAL611321
		G 1 1/2	RED-R 1 -WD/R 1 1/2	56.5	59	41	39.9	20	28.5	60	RED ... -WD/... VI-1.4571	WAL606632	WAL615411
400 (5801)	G 1 1/4 A	G 1	RED-R 1 1/4-WD/R 1	45.5	53	33	49.9	25	24.5	50	RED ... -WD/... VI-1.4571	WAL606633	WAL611629
250 (3626)	G 1 1/4 A	G 1 1/2	RED-R 1 1/4-WD/R 1 1/2	58.0	60	40	49.9	25	28.5	60	RED ... -WD/... VI-1.4571	WAL606634	WAL615483
	G 1 1/2 A	G 1 1/4	RED-R 1 1/2-WD/R 1 1/4	53.0	58	36	54.9	32	26.5	55	RED ... -WD/... VI-1.4571	WAL606635	WAL615231

△ Caution: The pressure specifications refer to the steel version. For the stainless steel version (1.4571), please refer to the pressure specifications on page B5.
 **FPM (e.g. Viton) see price list / available on request