

Tube connecting parts for WALPRO tube fittings

P-R ...

P-R ... -1.4571

- WALPRO profile ring

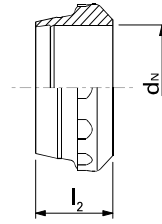

D

Profile ring
stainless steel (1.4571)
P-R...
-1.4571*

Profile ring
P-R...

Series	PN bar (psi)	Tube outer diameter d_N	Model	kg/ 100 pc.	l_2	Art. no.	Art. no.
LL	100 (1450)	4	S-R 4 LL	0.05	6	WAL039862	WAL029780
		6	S-R 6 LL	0.09	7	WAL039864	WAL029782
		8	S-R 8 LL	0.1	7	WAL039865	WAL029783
L	500 (7252)	6	P-R 6 L/S	0.2	9.8	WAL372404	WAL618843
		8	P-R 8 L/S	0.29	9.5	WAL372405	WAL618844
		10	P-R 10 L/S	0.39	10	WAL372406	WAL618845
	400 (5801)	12	P-R 12 L/S	0.45	9.5	WAL372407	WAL618846
		15	P-R 15 L	0.58	9.8	WAL372408	WAL618847
		18	P-R 18 L	0.73	9.8	WAL372409	WAL618848
		22	P-R 22 L	0.86	10.5	WAL372410	WAL618849
	250 (3626)	28	P-R 28 L	1.17	11	WAL372411	WAL618850
		35	P-R 35 L	2.31	13	WAL372412	WAL618851
		42	P-R 42 L	2.83	13	WAL372413	WAL618852
S	800 (11603)	6	P-R 6 L/S	0.2	9.8	WAL372404	WAL618843
		8	P-R 8 L/S	0.29	9.5	WAL372405	WAL618844
		10	P-R 10 L/S	0.39	10	WAL372406	WAL618845
	630 (9137)	12	P-R 12 L/S	0.45	9.5	WAL372407	WAL618846
		14	P-R 14 S	0.61	10	WAL372414	WAL618853
		16	P-R 16 S	0.74	10.3	WAL372415	WAL618854
		20	P-R 20 S	1.13	12	WAL372416	WAL618855
	420 (6091)	25	P-R 25 S	1.53	12	WAL372417	WAL618856
		30	P-R 30 S	2.13	13	WAL372418	WAL618857
		38	P-R 38 S	2.55	13	WAL372419	WAL618858

⚠ Caution: The pressure specifications refer to the steel version. For the stainless steel version (1.4571), please refer to the pressure specifications on page B5.